

P20-170

Manufacturer:
 PENDOCK, Halesfield 19, Telford, Shropshire, TF7 4QT.
 T: 01952 580590 E: sales@pendock.co.uk W: www.pendock.co.uk

Product Range: **PENDOCK RADIUS**
 Pendock Radius COLUMN CASINGS

Product Reference:
 MET-SQ-250

Product Description:
 A range of Metal (Aluminium / Stainless) column casings offering a vast array of robust, functional and highly-aesthetic casing systems to enclose structural elements within the building industry. Each individual range includes a number of flexible design options, allowing the designer to create and specify a precise column casing solution for any environment. Available for both interior and exterior locations in an extensive range of sizes, shapes and finishes. Aluminium alloy sheet (Grade 1050A-H14/4015-H12 to BS EN 485, BS EN 515 and BS EN 573)

Size:
 250mm X 250mm External Dims (Main Casing); 190mm X 190mm External Dims (Optional Recessed Feature Collar(s);

Length:
 Up to 4000mm in one piece as standard; casings can be 'stacked' to achieve heights over 4m.

Thickness:
 Aluminium - 3mm as standard with 2mm & 1.5mm also available.
 Stainless Steel - 2mm as standard with 1.5mm & 1mm also available.

Finish / Colour:
 Aluminium - Polyester Powder Coated to BS 6496 and BS EN 12206 to any RAL/BS/Pantone Colour - Textured Finishes available upon request
 Stainless Steel - Brushed / Polished and Patterned (RIMEX or similar)

Joining:
 20mm x 20mm Flush decorative insert channel to conceal fixings

Accessories:
 Decorative insert channels / joining features
 (Optional - Internal Framework Components)
 (Optional - Recessed Feature Collar for skirting and / or head locations)
 (Optional - Acoustic linings to meet specific requirements)
 (Optional - Access hatches / Rodding eye access hatches)

British Standards:
 We work to and follow British standards where applicable with metal products.
 Rolled products to BS EN 485
 Extruded products to BS EN 525 / BS EN 573 / BS EN 755
 External polyester powder coating to BS 6496/7

Fire classifications:
 Aluminium - Fire Performance as appropriate relating to BS 476 and EN13501-1.

Drawing References:
 MET-SQ-250

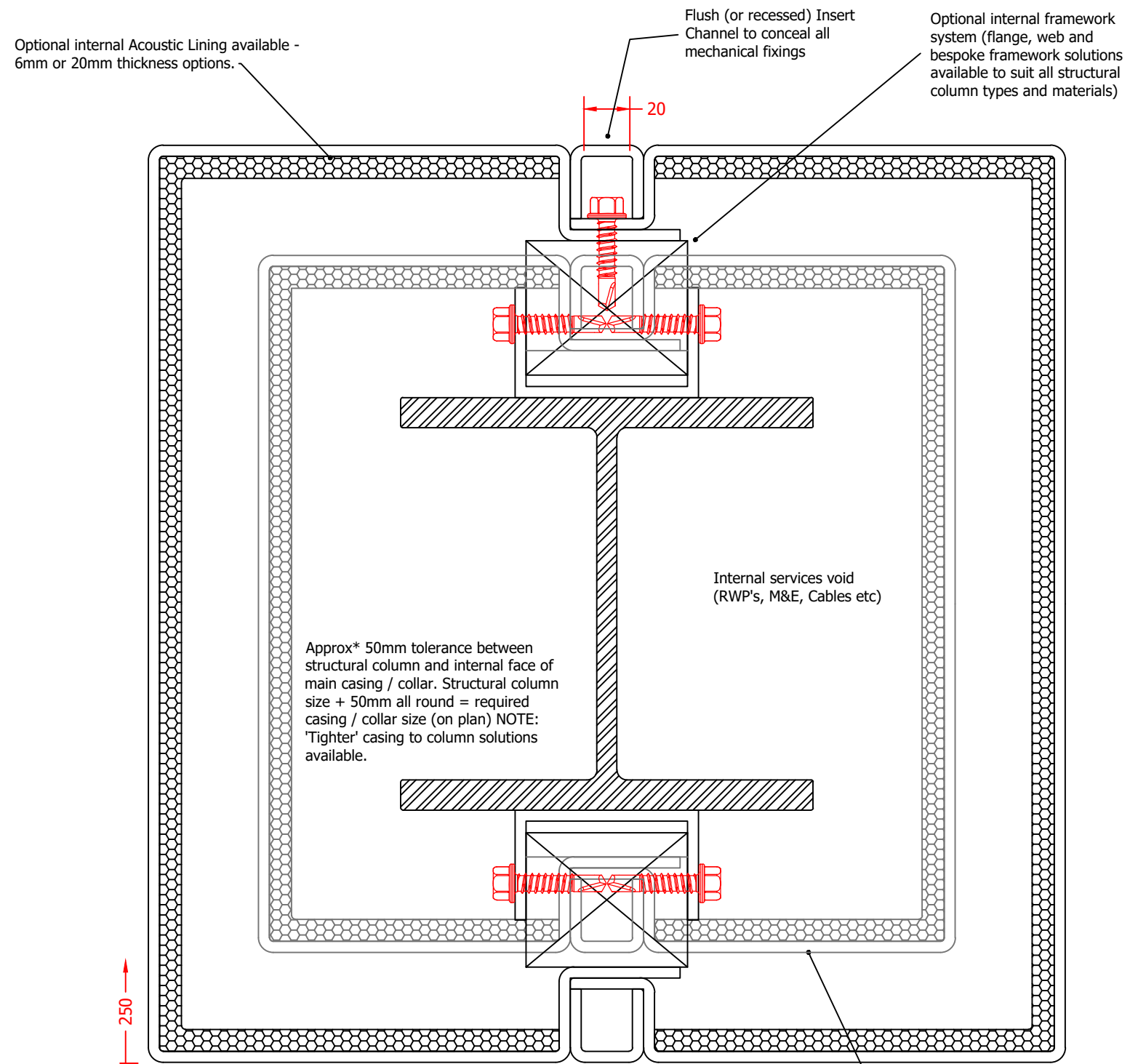

PLAN / SECTION A - A

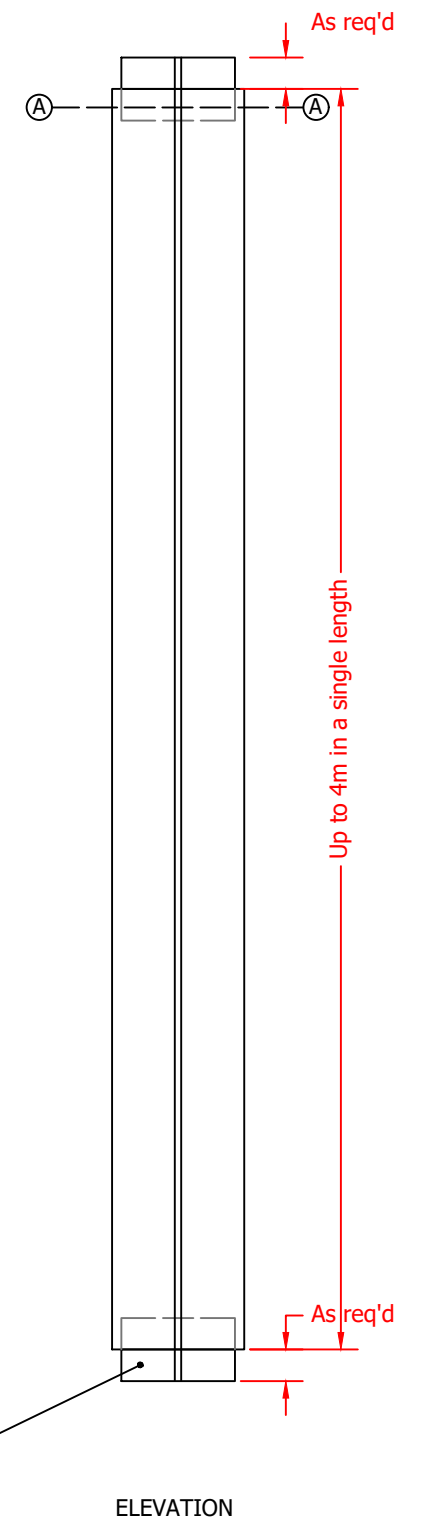

ELEVATION

PRODUCT RANGE:	PENDOCK RADIUS	
PRODUCT REF:	MET-SQ-250	
DRAWING No:	MET-SQ-250	
REVISION:	-	
CREATED:	1.1.20	
DRAWN BY:	TECHNICAL DEPARTMENT	PAPER SIZE
DWG SCALE(S):	NTS	-
COLOUR / FINISH REF:	PPC / BRUSHED / TEXTURED / PATTERNED	PROJECTION THIRD ANGLE

REV:	DATE:	REVISION:	INIT:
COPYRIGHT © 2020 ALL RIGHTS RESERVED - THIS DRAWING IS STRICTLY THE PROPERTY OF PENDOCK - (TP MANUFACTURING LTD)			

APPROVED BY:	
COMPANY:	
PRINT NAME:	
SIGNATURE:	
DATE:	



THE CASING & ENCLOSURE SPECIALIST

HALESFIELD 19
 TELFORD
 SHROPSHIRE TF7 4QT
 (t) 01952 580590 (f) 01952 587805
 sales@pendock.co.uk
 www.pendock.co.uk